

# Porthgwari

Penzance

## The Allen 3 bedroom home

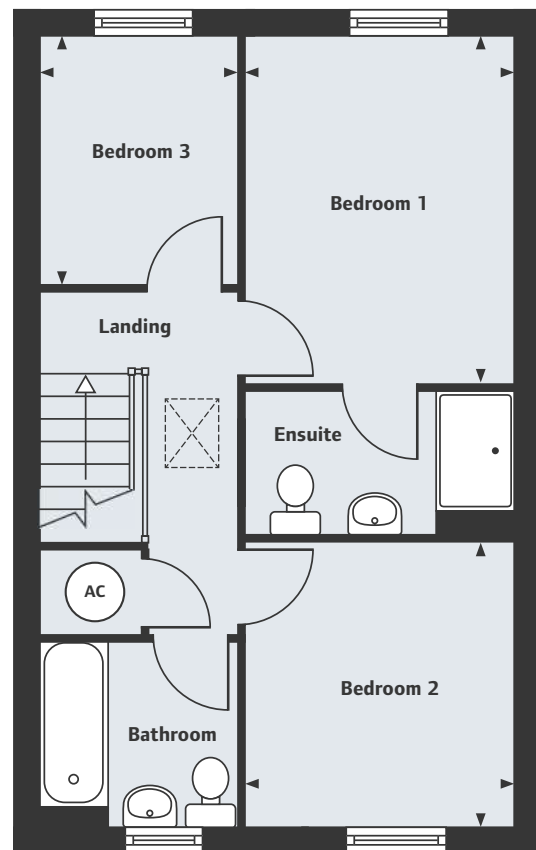
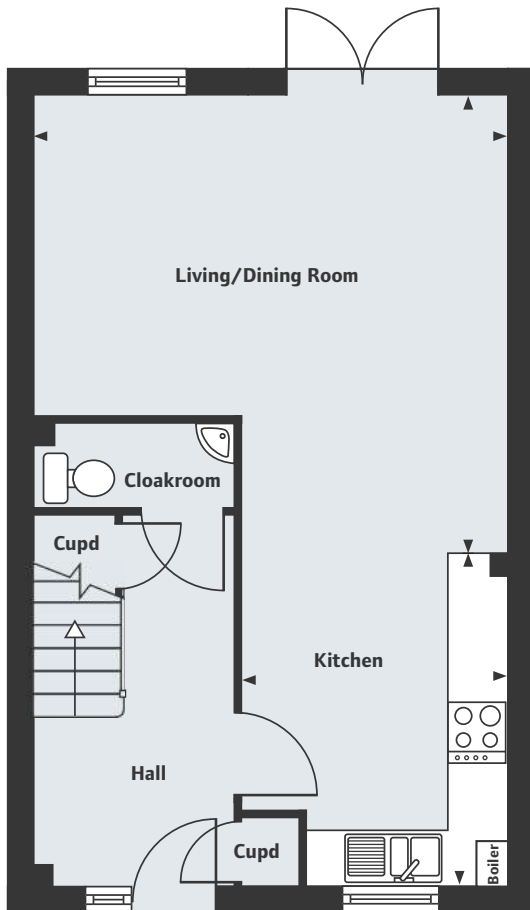

### Ground Floor

Living/Dining Room	4.89m x 4.77m	16'1" x 15'8"
Kitchen	3.48m x 2.71m	11'5" x 8'11"

### First Floor

Bedroom 1	3.62m x 2.80m	11'11" x 9'2"
Bedroom 2	2.97m x 2.80m	9'9" x 9'2"
Bedroom 3	2.59m x 1.97m	8'6" x 6'6"

Homes 28, 31, 47, 59, 60, 87 & 96 are mirror image.

For all sales enquiries please call  
**01736 664990**  
[lindenhomes.co.uk/porthgwari](http://lindenhomes.co.uk/porthgwari)

Please note, floorplans and dimensions are taken from architectural drawings and are for guidance only. Dimensions stated are within a tolerance of plus or minus 50mm. Overall dimensions are usually stated and there may be projections into these. With our continual improvement policy we constantly review our designs and specification to ensure we deliver the best product to our customers. Computer generated images not to scale. Finishes and materials may vary and landscaping is illustrative only. Kitchen layouts are indicative only and may change. To confirm specific details on our homes please ask your Sales Executive. LINCO135/January 2019.

  
**Linden**  
HOMES