

Beaumont Park
Phase 2
Ringwood

The Leverton
4 bedroom home

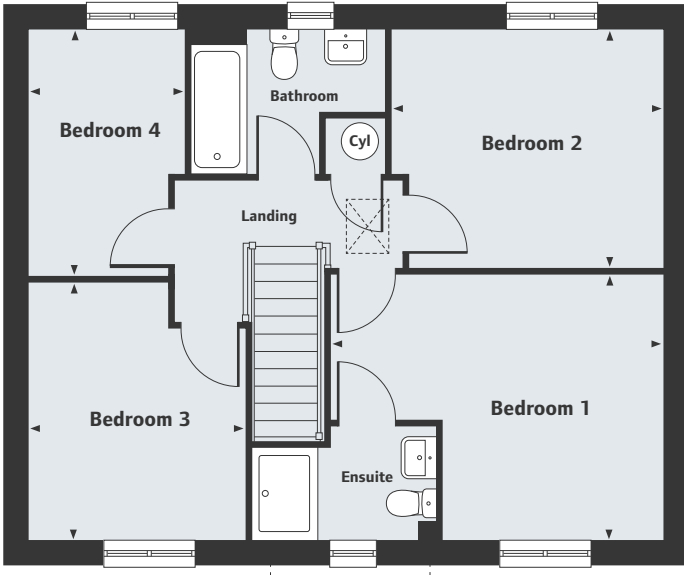

First Floor

Bedroom 1	4.41m x 3.49m	14'6" x 11'5"
Bedroom 2	3.60m x 3.15m	11'10" x 10'4"
Bedroom 3	3.38m x 2.89m	11'1" x 9'6"
Bedroom 4	3.26m x 2.09m	10'8" x 6'10"



Ground Floor

Living Room	4.82m x 3.40m	15'10" x 11'2"
Kitchen	3.24m x 2.80m	10'8" x 9'2"
Dining Area	3.92m x 2.81m	12'10" x 9'3"
Study	3.40m x 1.83m	11'2" x 6'0"



Loft hatch

F/F Integrated fridge freezer

Please note, floorplans and dimensions are taken from architectural drawings and are for guidance only. Dimensions stated are within a tolerance of plus or minus 50mm. Overall dimensions are usually stated and there may be projections into these. With our continual improvement policy we constantly review our designs and specification to ensure we deliver the best product to our customers. Computer generated images not to scale. Finishes and materials may vary and landscaping is illustrative only. Kitchen layouts are indicative only and may change. To confirm specific details on our homes please ask your Sales Executive. XLNS713/August 2018.

For all sales enquiries please call
01425 383 266
lindenhomes.co.uk/beaumontpark

