

Forester 4 Bedroom Homes

Liskerrett Vale Liskeard

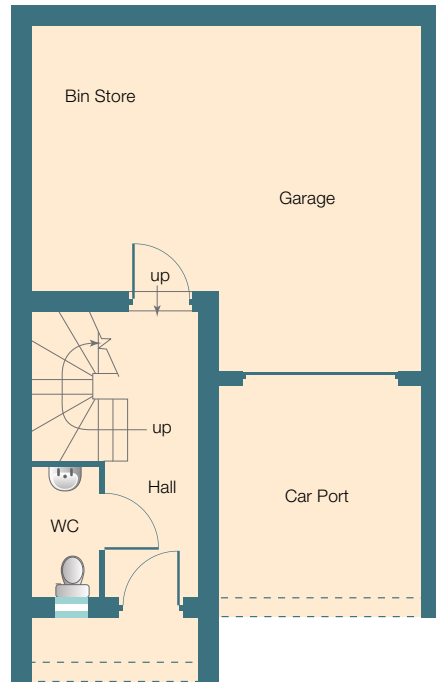

Ground Floor

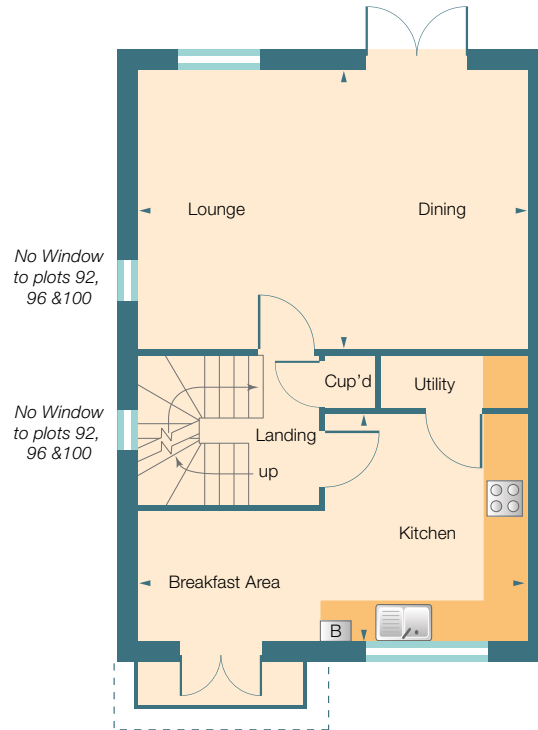

First Floor

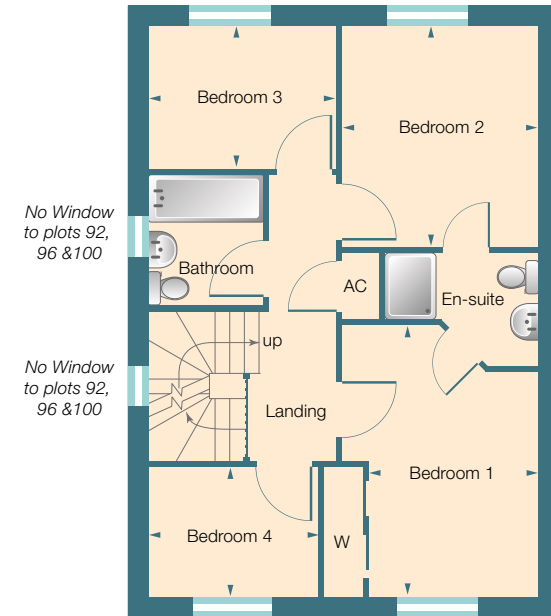

Second Floor

Homes 82, 92, 95, 96, 99, 100 & 103 (79 Handed)

Floor Area: 106.89 m² (1150.56 sq.ft) *excluding garage*

First Floor

Lounge/Dining	5690 x 4062 mm	18'8" x 13'3"
Kitchen/Breakfast	5690 x 3287 mm	18'8" x 10'9"

Second Floor

Bedroom 1	3962 x 2467 mm	12'11" x 8'1"
Bedroom 2	3212 x 2857 mm	10'6" x 9'4"
Bedroom 3	2737 x 2067 mm	8'11" x 6'9"
Bedroom 4	2457 x 1887 mm	8'0" x 6'2"

Dimensions to points shown ▶

Boiler **B**



Midas Homes Limited

Tamar House
 Forge Lane
 Moorlands Trading Estate
 Saltash
 Cornwall PL12 6LX
 Tel: 01752 845459
 Fax: 01752 844167

midashomes.com

Please note, floor plans and dimensions are taken from architectural drawings and are for guidance only. Dimensions stated are within a tolerance of plus or minus 50mm. Overall dimensions are usually stated and there may be projections into these. Finishes, materials, elevational treatments and landscaping may vary. Please ask your Sales Executive for specific details.

Forester 4 Bedroom Homes

Liskerrett Vale Liskeard



Homes 82, 92, 95, 96, 99, 100 & 103 (79 Handed)

The illustration shown here is not fully representative of ground levels and landscaping. Finishes may vary.

Stuart 3 Bedroom Homes

Liskerrett Vale Liskeard

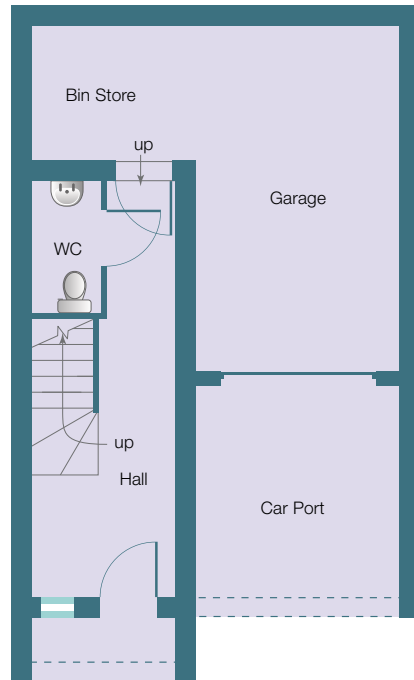

Ground Floor

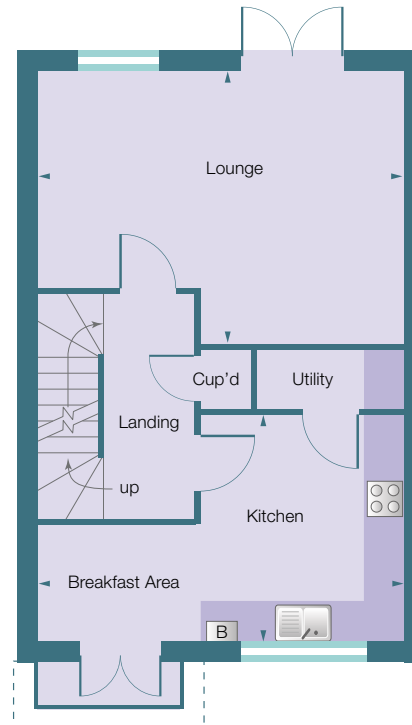

First Floor

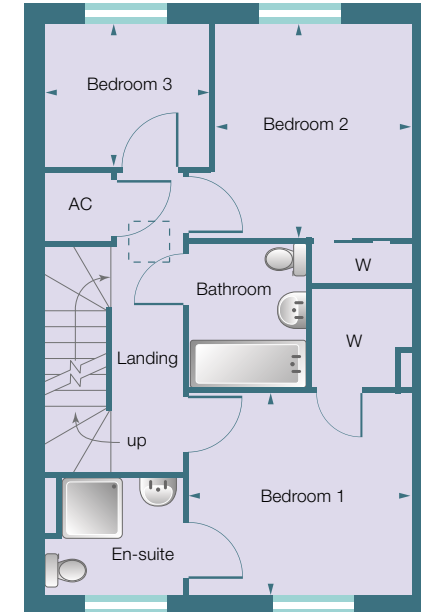

Second Floor

Homes 80, 81, 93, 94, 97, 98, 101 & 102

Floor Area: 103.53 m² (1114.39 sq.ft) *excluding garage*

First Floor

Lounge	5340 x 3987 mm	17'6" x 13'0"
Kitchen/Breakfast	5340 x 3287 mm	17'6" x 10'9"

Second Floor

Bedroom 1	3242 x 2932 mm	10'7" x 9'7"
Bedroom 2	2857 x 2137 mm	9'4" x 7'0"
Bedroom 3	2387 x 2067 mm	7'9" x 6'9"

Dimensions to points shown ▶

Boiler **B**



Midas Homes Limited

Tamar House
Forge Lane
Moorlands Trading Estate
Saltash
Cornwall PL12 6LX
Tel: 01752 845459
Fax: 01752 844167

midashomes.com

Please note, floor plans and dimensions are taken from architectural drawings and are for guidance only. Dimensions stated are within a tolerance of plus or minus 50mm. Overall dimensions are usually stated and there may be projections into these. Finishes, materials, elevational treatments and landscaping may vary. Please ask your Sales Executive for specific details.

Stuart 3 Bedroom Homes

Liskerrett Vale Liskeard



Homes 80, 81, 93, 94, 97, 98, 101 & 102

The illustration shown here is not fully representative of ground levels and landscaping. Finishes may vary.

Roseland 4 Bedroom Homes

Liskerrett Vale Liskeard

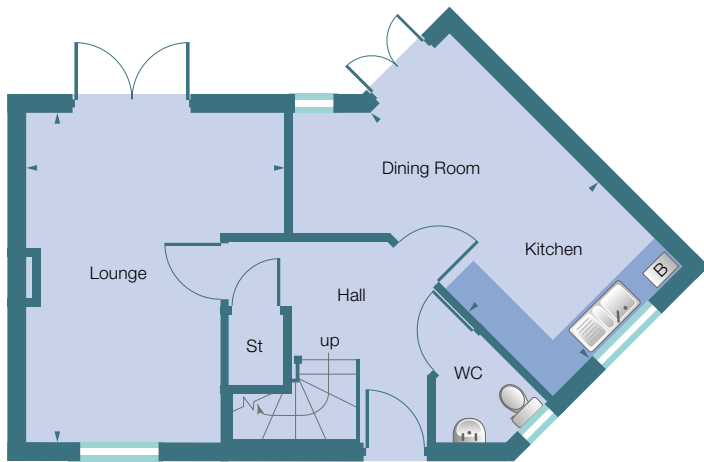

Ground Floor

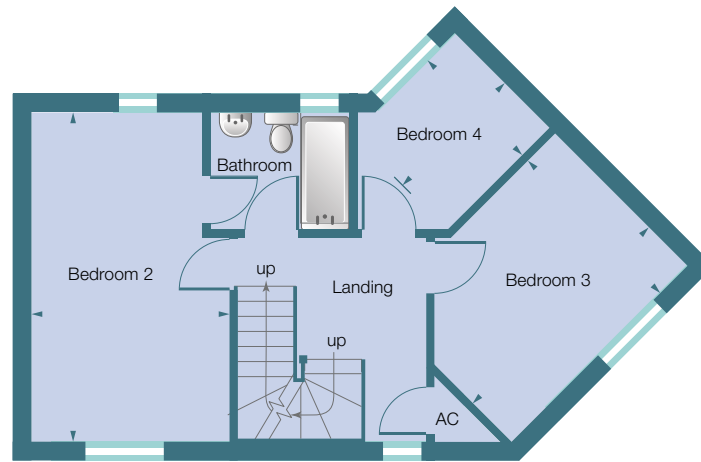

First Floor

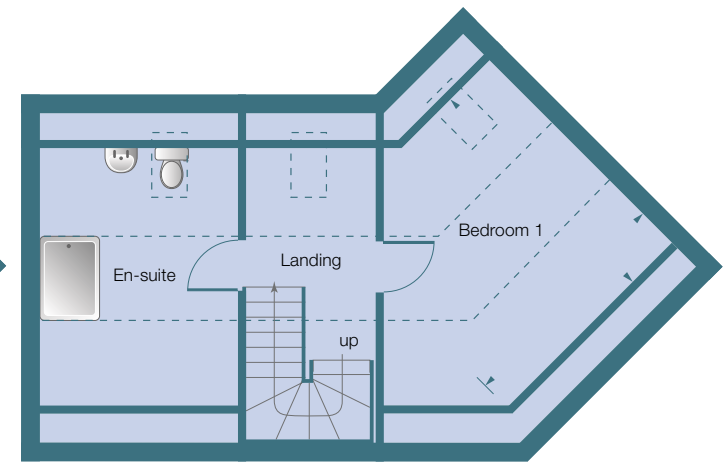

Second Floor

Homes 43 & 46 (44 Handed)

Floor Area: 135.08 m² (1454 sq.ft) *excluding garage*

Ground floor

Lounge 4950 x 3870mm 16'2" x 12'8"
 Kitchen/Dining 4950 x 2720mm 16'2" x 8'11"

First Floor

Bedroom 2 4950 x 2941mm 16'2" x 9'7"
 Bedroom 3 3720 x 2874mm 12'2" x 9'5"
 Bedroom 4 1979 x 2155mm 6'5" x 7'0"

Second Floor

Bedroom 1 3900 x 3525mm 12'9" x 11'6"



Midas Homes Limited

Tamar House
 Forge Lane
 Moorlands Trading Estate
 Saltash
 Cornwall PL12 6LX
 Tel: 01752 845459
 Fax: 01752 844167

Dimensions to points shown Boiler

Please note, floor plans and dimensions are taken from architectural drawings and are for guidance only. Dimensions stated are within a tolerance of plus or minus 50mm. Overall dimensions are usually stated and there may be projections into these. Finishes, materials, elevational treatments and landscaping may vary. Please ask your Sales Executive for specific details.

midashomes.com

Roseland 4 Bedroom Homes

Liskerrett Vale Liskeard



Homes 43, 44 & 46

The illustration shown here is not fully representative of ground levels and landscaping. Finishes may vary.

Upton 4 Bedroom Homes

Liskerrett Vale Liskeard

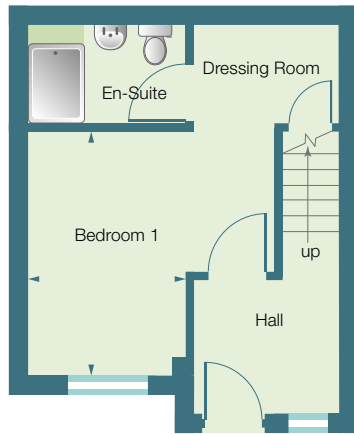

Ground Floor

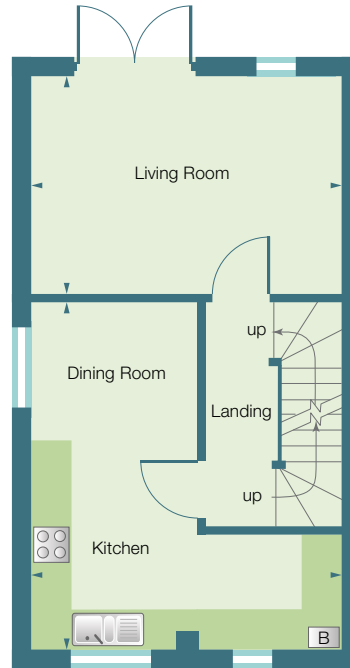

First Floor

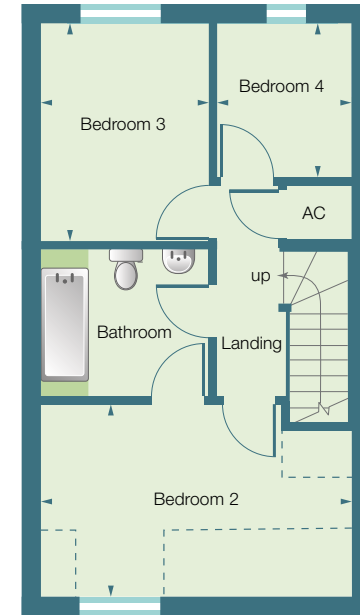

Second Floor

Homes 66 & 68 (67 & 69 Handed)

Floor Area: 103.40 m² (1113 sq.ft) *excluding garage*

Ground floor

Bedroom 1 3581 x 2343mm 11'8" x 7'8"
 Dressing Room 2110 x 1460mm 6'11" x 4'9"

First Floor

Lounge 4550 x 3190mm 14'11" x 10'5"
 Kitchen/Dining 5140 x 4550mm 16'10" x 14'11"

Second Floor

Bedroom 2 4550 x 2850mm 14'11" x 9'4"
 Bedroom 3 3184 x 2490mm 10'5" x 8'2"
 Bedroom 4 2185 x 1950mm 7'2" x 6'4"

Dimensions to points shown Boiler

Please note, floor plans and dimensions are taken from architectural drawings and are for guidance only. Dimensions stated are within a tolerance of plus or minus 50mm. Overall dimensions are usually stated and there may be projections into these. Finishes, materials, elevational treatments and landscaping may vary. Please ask your Sales Executive for specific details.



Midas Homes Limited

Tamar House
 Forge Lane
 Moorlands Trading Estate
 Saltash
 Cornwall PL12 6LX
 Tel: 01752 845459
 Fax: 01752 844167

midashomes.com

Upton 4 Bedroom Homes

Liskerrett Vale Liskeard



Homes 66, 67, 68 & 69

The illustration shown here is not fully representative of ground levels and landscaping. Finishes may vary.

Liskerrett Vale arrangement of homes

- Sold
- Darley - 4 bed home
- Roseland - 4 bed home
- Upton - 4 bed home
- Bicton - 2 bed coach house
- Forester - 4 bed home
- Stuart - 3 bed home
- Kingston - 3 bed home
- Fennel - 4 bed home
- Affordable home
(being provided under terms of planning agreement)



Not to scale.

Please note that there is a possibility that some additional homes may be made available as affordable homes for the local community. Please ask the Sales Executive for more information. Trees and landscaping are indicative only and may alter during construction. The trees, shrubs and gardens shown are illustrative only.



midashomes.com

Liskerrett Vale homes



Darley, 4 bedroom
Home 41



Roseland, 4 bedroom
Homes 43, 44, 46



Upton, 4 bedroom
Homes 65, 66, 67, 68, 69



Bicton, 2 bed coach house
Home 78



Forester, 4 bedroom
Homes 79, 82, 92, 95, 96, 99, 100, 103



Stuart, 3 bedroom
Homes 80, 81, 93, 94, 97, 98, 101, 102



Kingston, 3 bedroom
Homes 89, 90, 91



Fennel, 4 bedroom
Homes 135, 136, 137